

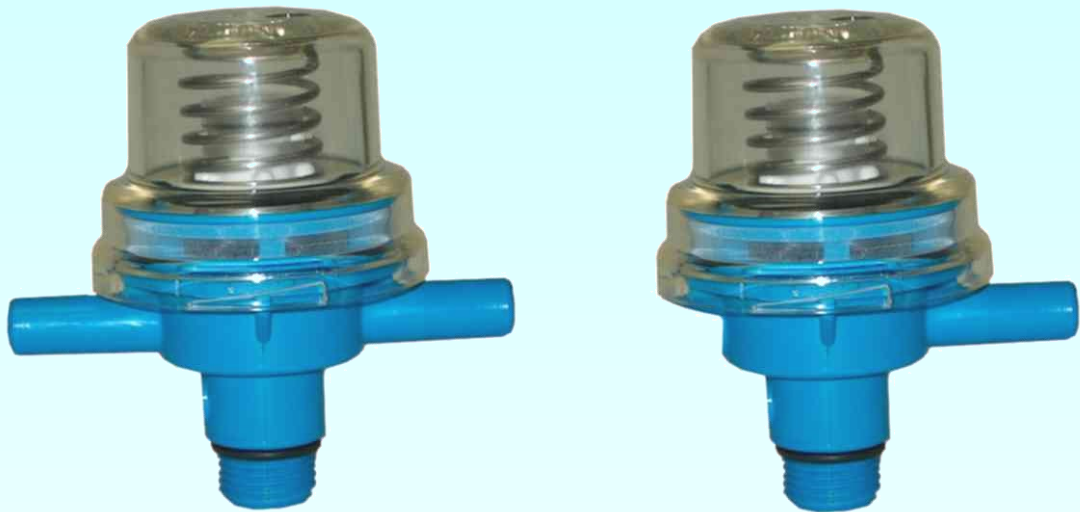

PULSTAR

Vacuum Operated Pulsation



- ★ Available in both dual and single units, the vacuum operated PULSTAR pulsator provides a technically sound and low cost alternative to electronic and pneumatic pulsation.
- ★ There is no worry about electrical contacts or wiring for the pulsators or sticking slide mechanisms. This is not only less irritating to you, but it is also better for your cows. With positive, reliable pulsation, milking is faster and udder health is improved.
- ★ The PULSTAR is very simple having only 3 moving parts and no lubrication is required. If it is accidentally dropped in the gutter, not to worry, unscrew the cap with a 1/4 turn and hose it out. Water does not hurt the PULSTAR.
- ★ Aside from normal cleaning, scheduled maintenance is recommended at 2,000 hour intervals or annually whichever occurs first. Pulsator Repair Kits are available to replace all wearing parts and can be installed without special training or tools.
- ★ The clear dome allows full view of the pulsator mechanism so if something happened to foul the unit it would be immediately apparent. Getting the unit back into operation is as simple as removing the dome and components to spot the problem and correct it.
- ★ PULSTAR pulsators will work with any milker unit and on any system. They can be installed one at a time with existing pulsators, so the cost can be spread out over time.



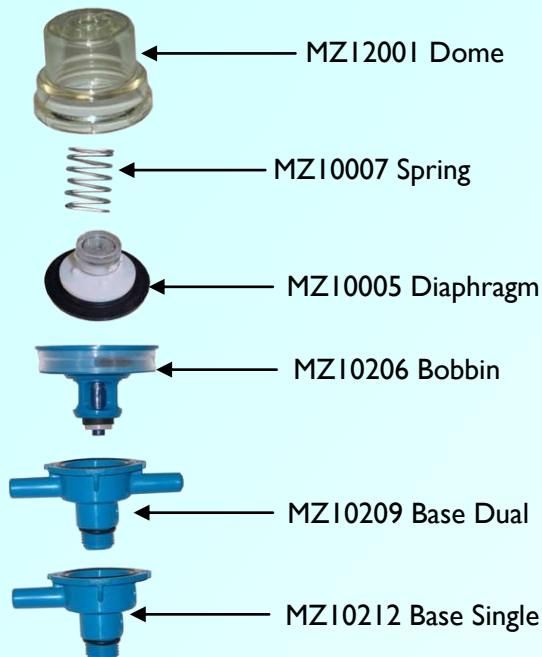

Disassemble by turning the dome 1/4 turn counterclockwise.

Wash components in a mild soapy solution as needed.

Replace diaphragm complete, bobbin valve, bobbin "O" ring and middle "O" ring at 2,000 hours of operation or annually - whichever occurs first.

Pulsator repair kits are available at reduced prices.

Pulstar Installations

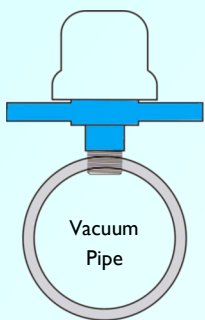

For stationary mount, the PULSTAR can be threaded directly into the vacuum line. One PULSTAR will operate two milker units.

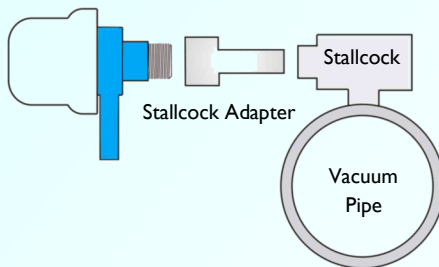

For portable use, the PULSTAR can be connected to any major brand of stallcock with the applicable stallcock adapter. The PULSTAR works in both vertical and horizontal positions

Specifications

Milk-to-Rest Ratio - 60:40 \pm 5%
(meets ISO standard)

Rate - adjustable between 48 and 80 pulses per minute

Sequence - 4 x 1

Air consumption - .5 Cu. Ft. per Min.

Vacuum Hose Requirement - 3/8" I.D. pulsation hose recommended

Mounting fitting - 1/2" NPT

Stallcock Adapters - Available for all major brands.

Visit our web at:
www.nupulse.com and
www.ezeemilkingcatalog.com



4904 Triangle St., Suite A, McFarland, WI 53558

Ph: 1-800-233-6878 • Fax: 1-608-838-2221

email: nupulse@nupulse.com